

Parc des Collines

Mulhouse

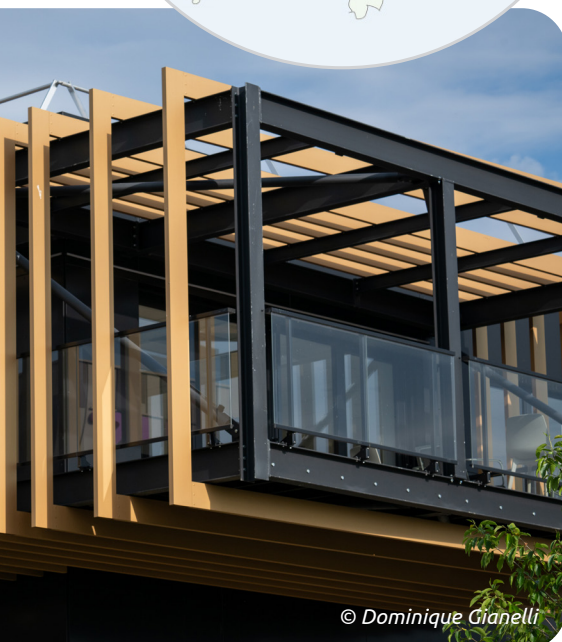

Located near the city center, with **easy access to highways**, and **adjacent to a scientific university hub**, the Parc des Collines is situated on the western side of the city **in a green environment**, with **36%** of the area dedicated to **green spaces**.

The park offers **various services** and is **accessible by bus and tram**. It is intended for **tertiary, technological, and non-polluting industrial activities**, currently

hosting **620 companies** and **4,000 employees**. Notable businesses include Chronopost, Cocktails, Plastrance, La Poste, Final Advanced Materials, CAD'Indus, Veritas, among others.

imagine

Alsace

FOR YOUR LIFE AND BUSINESS

Parc des Collines Mulhouse



SURFACE

Planned total area:	150 ha
Available area:	14 ha
Smallest available plot:	0.4 ha



BUSINESSES OPERATING NEARBY

DMC, CAD'Indus, COVED, Dollfus & Muller, Mitsubishi Heavy Industry, Stellantis Mulhouse, Superba, Plastiques Pöppelmann France...



FACILITIES

Water supply:	yes
Power supply:	yes medium voltage available
Gas supply:	available upon request
High-Speed Internet:	yes



ACCESSIBILITY

Motorway A36:	1 km
Motorway A35:	14 km
EuroAirport	
Basel-Mulhouse-Freiburg:	36 km
Basel:	42 km
Strasbourg:	117 km



ADIRA.Alsace



ADIRA.Alsace



@ADIRA_Alsace

Jean-Michel Staerlé

+33 (0)3 88 52 82 82 | jean-michel.staerle@adira.com

www.adira.com | e-mail : alsace@adira.com